

ARCHITECTS BEAZLEY MOLIERE  
A Professional Architectural Corporation  
P. O. Box 51877  
Lafayette, Louisiana 70505

RE: HURRICANE IDA REPAIRS TO  
TPCG BAYOU COUNTRY SPORTSPLEX  
200 BAYOU COUNTRY ROAD  
HOUMA, LOUISIANA 70360  
ABM PROJECT NO. 201022.00

Issued: November 15, 2023

ADDENDUM NO. 2

This addendum shall become a permanent part of the above referenced project and shall alter the plans and specifications as follows:

ITEM NO. 1 - CLARIFICATIONS

Albert F. Moliere III, AIA

1. Bid bonds shall be furnished in the amount of 5 percent (5%) of the submitted Bid per LA Public Bid Law.

Scott B. Chappuis, AIA

2. The following turf grass products are approved for use on this Project:

Thomas D. Hughes, PM

- (1) Synlawn Synplay 48 (+Pad).
- (2) Synlawn Golf Classic Pitch USA.
- (3) Synlawn Synplay 48 (No Pad).
- (4) Synlawn Golf Precision Putt.

Charles D. Beazley  
Retired

ITEM NO. 2 - SPECIFICATION SECTION 08 33 23 – OVERHEAD COILING DOORS

Remove and replace the above referenced specification section with attached SPECIFICATION SECTION 08 33 23R – OVERHEAD COILING DOORS.

ITEM NO. 3 - SHEET NO. C101 – SITE PLAN

Remove Sheet C101 and replace with attached Sheet C101R bearing revision date 11/15/2023.

ITEM NO. 4 - SHEET NO. C102 – ENLARGED SITE PLANS

Remove Sheet C102 and replace with attached Sheet C102R bearing revision date 11/15/2023.

ITEM NO. 5 - SHEET NO. C103 – ENLARGED SITE PLANS

Remove Sheet C103 and replace with attached Sheet C103R bearing revision date 11/15/2023.

ITEM NO. 6 - SHEET NO. A101 – FIRST FLOOR PLAN

Remove Sheet A101 and replace with attached Sheet A101R bearing revision date 11/15/2023.

End Addendum No. 2

SECTION 08 33 23R - OVERHEAD COILING DOORS



PART 1 - GENERAL

1.1 SUMMARY

- A. Section Includes: Manually operated overhead coiling doors, operators, controls and accessories.

1.2 REFERENCES

- A. General: Standards listed by reference, including revisions by issuing authority, form a part of this specification section to the extent indicated. Standards listed are identified by issuing authority, authority abbreviation, designation number, title or other designation established by issuing authority. Standards subsequently referenced herein are referred to by issuing authority abbreviation and standard designation.

1.3 PERFORMANCE REQUIREMENTS

- A. Structural Performance:
  - 1. Wind Loads: Meet all local codes and standards.

1.4 SUBMITTALS

- A. General: Submit listed submittals in accordance with Conditions of the Contract and Division 1 Submittal Procedures Section.
- B. Product Data: Submit manufacturer's product data and installation instructions.
- C. Shop Drawings: Provide drawings indicating guide details, head and jamb conditions, clearances, anchorage, accessories, finish colors, patterns and textures, operator mounts and other related information.
- D. Quality Assurance Submittals: Submit the following:
  - 1. Certificates: Submit manufacturer's certificate that products meet or exceed specified requirements.
  - 2. Certificates: Submit installer qualifications.
- E. Closeout Submittals: Submit the following:
  - 1. Warranty documents available at [www.raynor.com](http://www.raynor.com) or your authorized Raynor dealer.

1.5 QUALITY ASSURANCE

- A. Installer Qualifications: Utilize an installer having demonstrated experience on projects of similar size and complexity, and trained and authorized by the door dealer to perform the Work of this section.

- B. Preinstallation Meetings: Verify project requirements, substrate conditions, manufacturer's installation instructions and manufacturer's warranty requirements. Comply with Division 1 Project Management and Coordination (Project Meetings) Section.

1.6 DELIVERY, STORAGE & HANDLING

- A. General: Comply with Division 1 Product Requirements.
- B. Comply with manufacturer's ordering instructions and lead time requirements to avoid construction delays.
- C. Delivery: Deliver materials in manufacturer's original, unopened, undamaged containers with identification labels intact.
- D. Storage and Protection: Store materials protected from exposure to harmful environmental conditions and at temperature and humidity conditions recommended by the manufacturer.

1.7 WARRANTY

- A. Project Warranty: Refer to Conditions of the Contract for Project warranty provisions.
- B. Manufacturer's Warranty: Submit, for Owner's acceptance, manufacturer's standard warranty document executed by authorized company official. Manufacturer's warranty is in addition to, and not a limitation of, other rights Owner may have under Contract Documents.
  - 1. Warranty: One (1) year from date of Substantial Completion.

PART 2 - PRODUCTS

2.1 MANUFACTURER

- A. Match Existing

2.2 DOOR OPERATORS – NOTE USED

2.3 CURTAIN

- A. Material: Match Existing
  - 1. Slat Type: Match Existing
- B. Color and Finish: Match Existing
- E. Bottom Bar and Seal: Match Existing

- 2.4 GUIDES – NOT USED
- 2.5 COUNTERBALANCE SYSTEM – NOTE USED
- 2.6 ENCLOSURES – NOT USED
- 2.7 HARDWARE
  - A. Locks: Reuse existing hardware

PART 3 - EXECUTION

- 3.1 MANUFACTURER'S INSTRUCTIONS
  - A. Comply with instructions and recommendations of door manufacturer.
- 3.3 EXAMINATION
  - A. Site Verification of Conditions: Verify through direct observation and field measurement that site conditions are acceptable for installation of doors, operators, controls and accessories. Ensure that openings square, flush and plumb.
  - B. Do not proceed with installation of doors, operators, controls and accessories until unacceptable conditions are corrected.
- 3.4 INSTALLATION
  - A. General: Install door, guide and operating equipment complete with all necessary accessories and hardware according to Shop Drawings, manufacturer's instructions.
- 3.5 ADJUSTING
  - A. General: Lubricate bearings and sliding parts, and adjust doors for proper operation, balance, clearance and similar requirements.
- 3.6 CLEANING
  - A. Remove temporary coverings and protection of adjacent work areas. Repair or replace installed products damaged prior to or during installation.
  - B. Clean installed products in accordance with manufacturer's instructions prior to Owner's acceptance. Remove and legally dispose of construction debris from Project site.

END OF SECTION 08 33 23

These drawings are the property of Architects Bezalley Moliere and may not be used or copied in whole or in part without the written consent of the architect. Any infringement is subject to legal action.

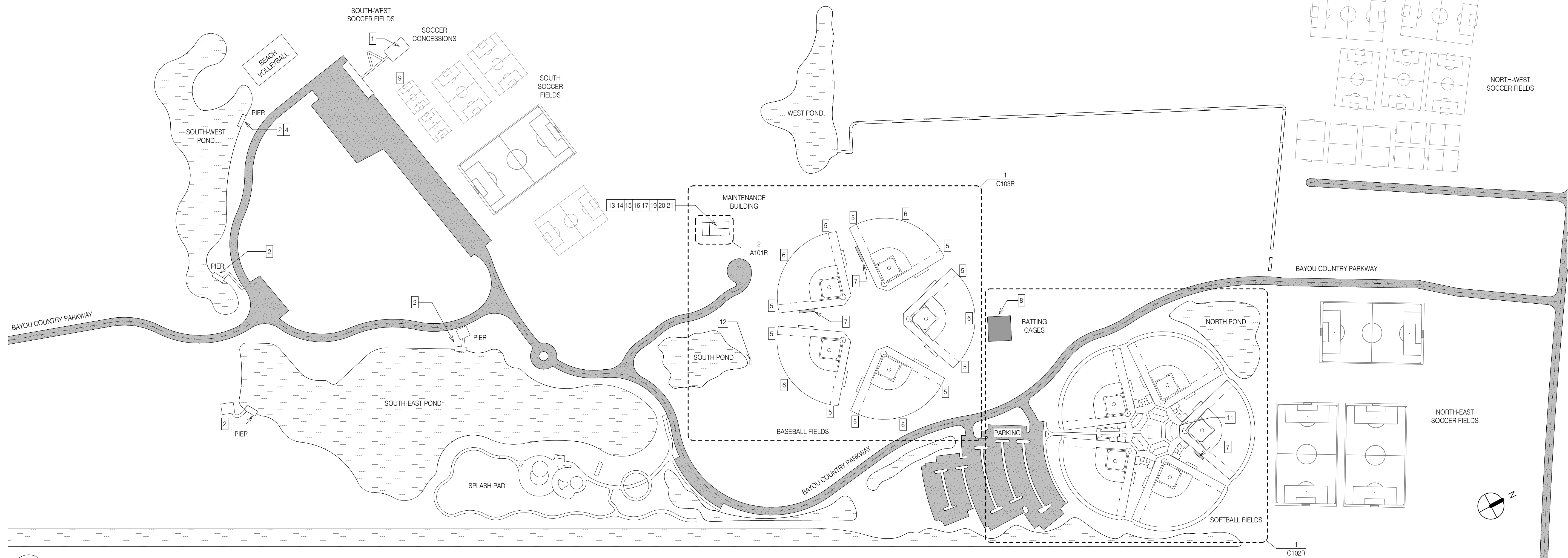

- ### REPAIR NOTES
1. REMOVE ALL 23 RECESSED LED SOFFIT LIGHT FIXTURES AND REPLACE WITH LIKE KIND. RE: A501 PHOTO #1
  2. REPLACE ALL 20 MISSING PVC PILE CAPS WITH LIKE KIND. RE: A501 PHOTO #2
  3. NOT IN USE
  4. REPLACE MISSING BULKHEAD TOP PLATE WITH LIKE KIND. RE: A501 PHOTO #3
  5. REMOVE FOUL POLE SLEEVES. REPLACE FOUL POLES, FLAGS, AND SLEEVES WITH LIKE KIND. COORDINATE EXACT LOCATION TO MEET LEAGUE REGULATIONS WITH THE PARK MANAGER. RE: A501 PHOTO #4-6
  6. REPLACE MISSING YELLOW FENCE CAP WITH LIKE KIND. APPROXIMATELY 343 LINEAR FEET PER BALL FIELD. REUSE EXISTING FENCE CAP WHEN POSSIBLE. RE: A501 PHOTO #5, 6
  7. REMOVE DAMAGED DUGOUT ROOF AND REPLACE DAMAGED/MISSING DUGOUT ROOF WITH LIKE KIND. RE: A501 PHOTO #7
  8. REPLACE MISSING ARTIFICIAL TURF GRASS THROUGHOUT THE ENTIRE BATTING CAGE WITH LIKE KIND. INSTALL USING PRESSURE TREATED WOOD OR PLASTIC LUMBER ATTACHED TO THE SIDES OF THE SLAB. RE: A501 PHOTO #8
  9. REPLACE DAMAGED 15 FOOT LONG, 3-TIER METAL BLEACHER WITH LIKE KIND. RE: A501 PHOTO #9
  10. REPLACE MISSING COMMERCIAL SIGNAGE WITH LIKE KIND. (30' x 60' 3MM ALUMINUM COMPOSITE SPONSOR SIGNS)
  11. REPLACE MISSING PA SPEAKER WITH LIKE KIND. RE: A501 PHOTO #10 (PRO 100 WEATHERPROOF OUTDOOR/INDOOR - RECTANGULAR SPEAKER CABINET 10" WOOFER W/ 2" HORN W/ 70 V TRANSFORMER - BLACK
  12. REPLACE DAMAGED/MISSING METAL CANOPY AT WATER PUMP WITH LIKE KIND. RE: A501 PHOTO #11
  13. REPLACE DAMAGED/MISSING SURVEILLANCE CAMERA WITH LIKE KIND. RE: A501 PHOTO #12 (1 EA.)
  14. REMOVE DAMAGED GUTTER AND REPLACE WITH LIKE KIND. RE: A501 PHOTO #13
  15. REMOVE DAMAGED DOWNSPOUTS AND REPLACE ALL 3 DAMAGED / MISSING DOWNSPOUTS WITH LIKE KIND. RE: A501 PHOTO #13
  16. REMOVE DAMAGED METAL WALL PANEL AND REPLACE WITH LIKE KIND. RE: A501 PHOTO #14
  17. REMOVE DAMAGED METAL CORNER TRIM AND REPLACE WITH LIKE KIND. RE: A501 PHOTO #15
  18. NOT IN USE
  19. REMOVE DAMAGED OVERHEAD ROLL-UP DOOR AND REPLACE WITH LIKE KIND. RE: A501 PHOTO #16
  20. REMOVE THE REMAINS OF METAL AWNING SYSTEM AND REPLACE WITH LIKE KIND. PROVIDE COLUMNS, BRACKETS, HEADWALL FLASHING, RAKE AND EAVE TRIM AS REQUIRED BY MANUFACTURER TO MEET WIND LOADS. RE: A501 PHOTO #9
  21. REMOVE DAMAGED METAL ROOF PANELS AND REPLACE WITH LIKE KIND. RE: A501 PHOTO #17

SITE PLAN

**ARCHITECTS BEZALLEY MOLIÈRE**  
  
 337 233 0614  
 FAX 233 7338  
 300 HEYMANN BOULEVARD  
 LAFAYETTE, LOUISIANA 70603

**HURRICANE IDA REPAIRS TO TPCG BAYOU COUNTRY SPORTSPLEX**  
 200 BAYOU COUNTRY PARKWAY  
 HOUMA, LOUISIANA 70360

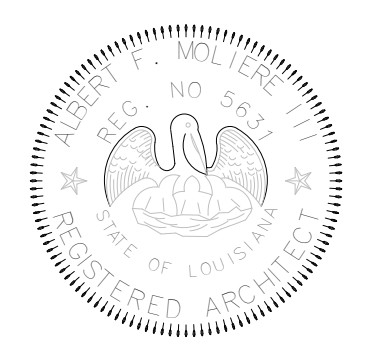

DATE ISSUED **10/11/2023**

REVISED

NO.	DESCRIPTION	DATE
1	ADDENDA No. 2	11/15/23

DRAWN BY \_\_\_\_\_ JBH

CHECKED BY \_\_\_\_\_ SBC

PROJECT NO. **202316.00**

SHEET NO. \_\_\_\_\_

These drawings are the property of Architects Bezalley Moliere and may not be used or copied in whole or in part without the written consent of the architect. Any infringement is subject to legal action.

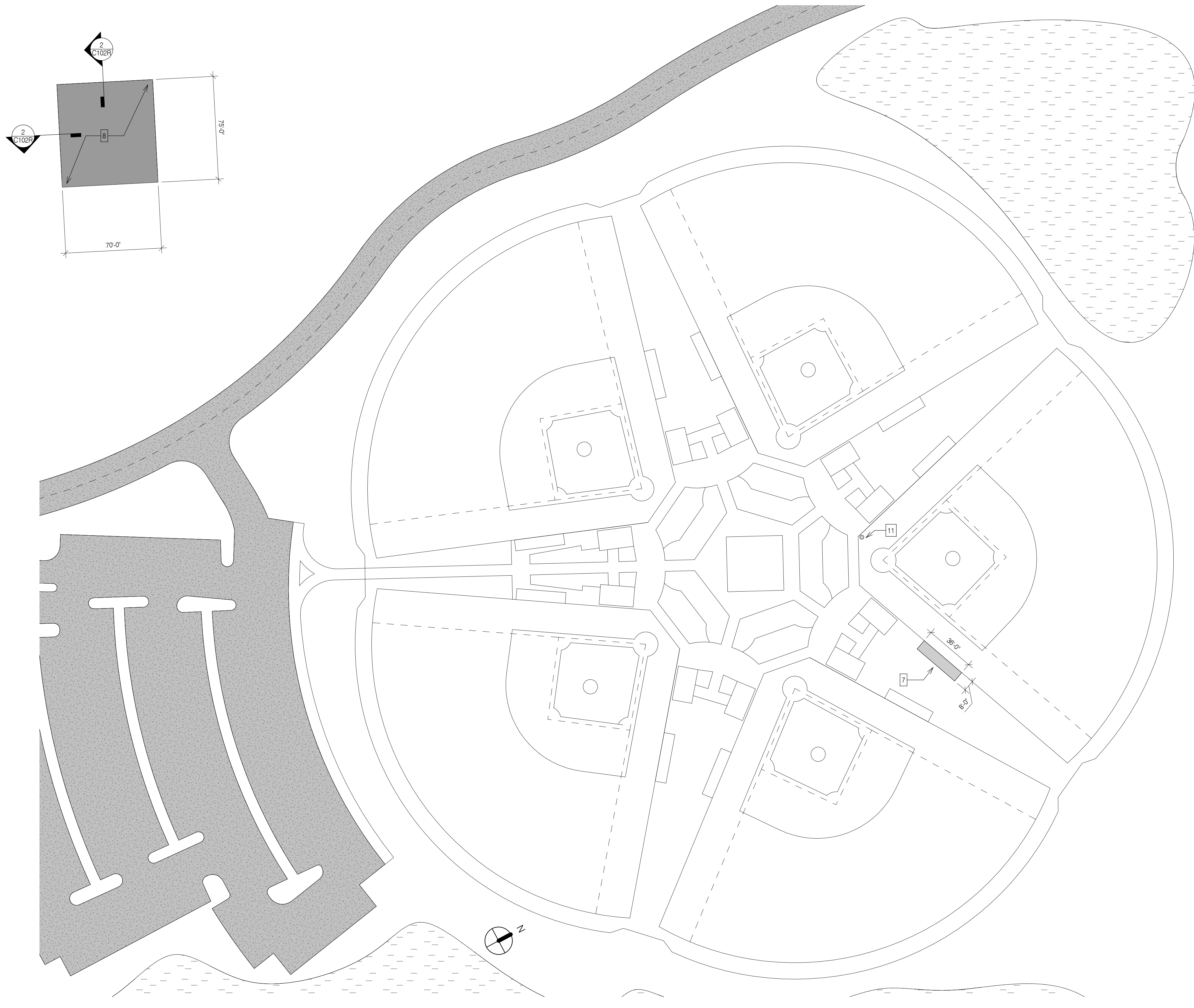

1 SOFTBALL FIELDS  
1" = 40'-0"

- ### REPAIR NOTES
1. REMOVE ALL 23 RECESSED LED SOFFIT LIGHT FIXTURES AND REPLACE WITH LIKE KIND. RE: A501 PHOTO #1
  2. REPLACE ALL 20 MISSING PVC PILE CAPS WITH LIKE KIND. RE: A501 PHOTO #2
  3. NOT IN USE
  4. REPLACE MISSING BULKHEAD TOP PLATE WITH LIKE KIND. RE: A501 PHOTO #3
  5. REMOVE FOUL POLE SLEEVES. REPLACE FOUL POLES, FLAGS, AND SLEEVES WITH LIKE KIND. COORDINATE EXACT LOCATION TO MEET LEAGUE REGULATIONS WITH THE PARK MANAGER. RE: A501 PHOTO #4-6
  6. REPLACE MISSING YELLOW FENCE CAP WITH LIKE KIND. APPROXIMATELY 343 LINEAR FEET PER BALL FIELD. REUSE EXISTING FENCE CAP WHEN POSSIBLE. RE: A501 PHOTO #5, 6
  7. REMOVE DAMAGED DUGOUT ROOF AND REPLACE DAMAGED/MISSING DUGOUT ROOF WITH LIKE KIND. RE: A501 PHOTO #7
  8. REPLACE MISSING ARTIFICIAL TURF GRASS THROUGHOUT THE ENTIRE BATTING CAGE WITH LIKE KIND. INSTALL USING PRESSURE TREATED WOOD OR PLASTIC LUMBER ATTACHED TO THE SIDES OF THE SLAB. RE: A501 PHOTO #8
  9. REPLACE DAMAGED 15 FOOT LONG, 3-TIER METAL BLEACHER WITH LIKE KIND. RE: A501 PHOTO #9
  10. REPLACE MISSING COMMERCIAL SIGNAGE WITH LIKE KIND. (30' x 60' 3MM ALUMINUM COMPOSITE SPONSOR SIGNS)
  11. REPLACE MISSING PA SPEAKER WITH LIKE KIND. RE: A501 PHOTO #10 (PRO 100 WEATHERPROOF OUTDOOR/INDOOR - RECTANGULAR SPEAKER CABINET 10" WOOFER W/ 2" HORN W/ 70 V TRANSFORMER - BLACK)
  12. REPLACE DAMAGED/MISSING METAL CANOPY AT WATER PUMP WITH LIKE KIND. RE: A501 PHOTO #11
  13. REPLACE DAMAGED MISSING SURVEILLANCE CAMERA WITH LIKE KIND. RE: A501 PHOTO #12 (1 EA.)
  14. REMOVE DAMAGED GUTTER AND REPLACE WITH LIKE KIND. RE: A501 PHOTO #13
  15. REMOVE DAMAGED DOWNSPOUTS AND REPLACE ALL 3 DAMAGED / MISSING DOWNSPOUTS WITH LIKE KIND. RE: A501 PHOTO #13
  16. REMOVE DAMAGED METAL WALL PANEL AND REPLACE WITH LIKE KIND. RE: A501 PHOTO #14
  17. REMOVE DAMAGED METAL CORNER TRIM AND REPLACE WITH LIKE KIND. RE: A501 PHOTO #15
  18. NOT IN USE
  19. REMOVE DAMAGED OVERHEAD ROLL-UP DOOR AND REPLACE WITH LIKE KIND. RE: A501 PHOTO #16
  20. REMOVE THE REMAINS OF METAL AWNING SYSTEM AND REPLACE WITH LIKE KIND. PROVIDE COLUMNS, BRACKETS, HEADWALL FLASHING, RAKE AND EAVE TRIM AS REQUIRED BY MANUFACTURER TO MEET WIND LOADS. RE: A501 PHOTO #9
  21. REMOVE DAMAGED METAL ROOF PANELS AND REPLACE WITH LIKE KIND. RE: A501 PHOTO #17

- ### GENERAL NOTES
1. WRAP ALL FOUR EDGES AND STAPLE THE TURF TO THE NAILER BOARDS PER MANUFACTURER.
  2. GLUE SEAMS USING SEAM TAPE PER MANUFACTURER.

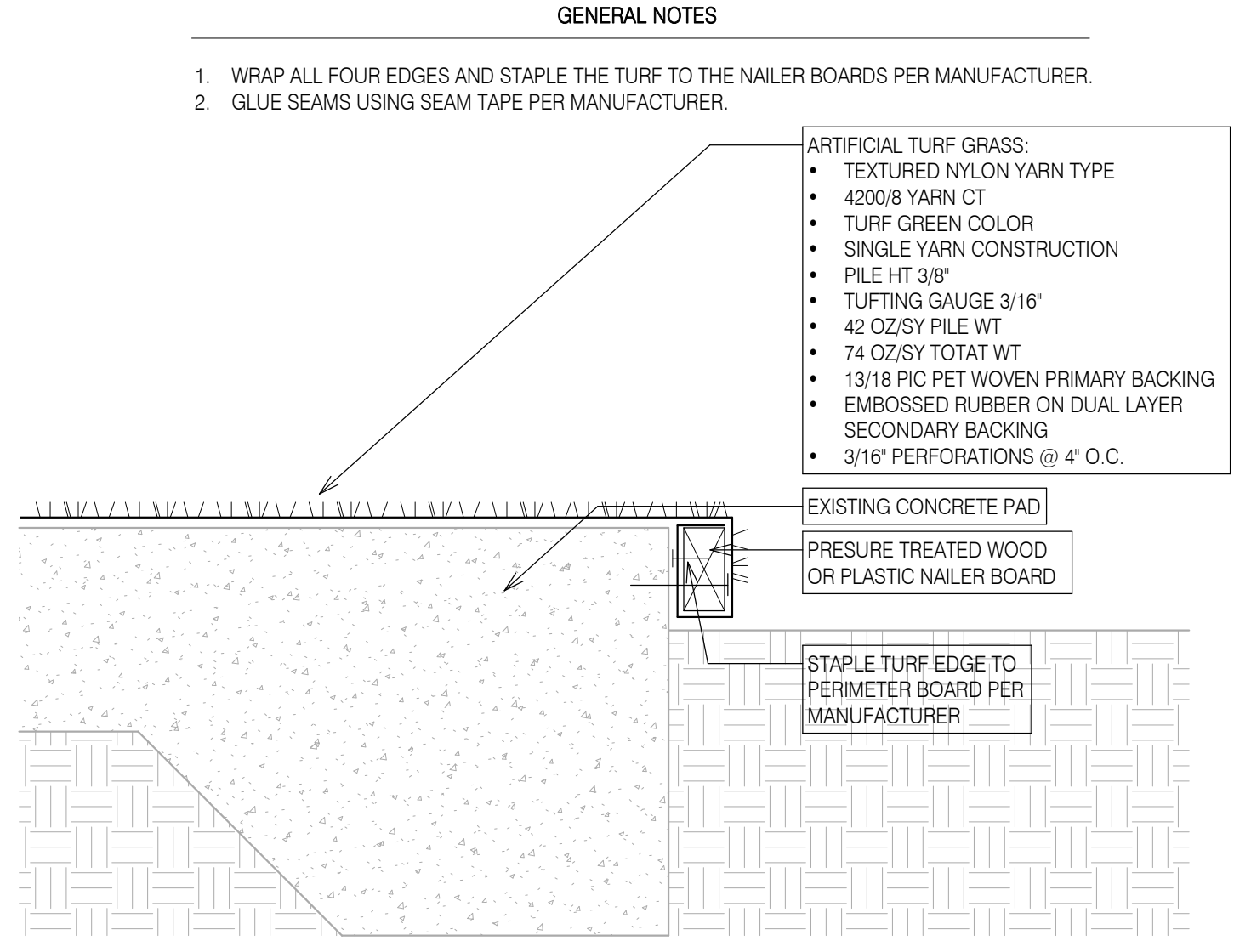

2 ARTIFICIAL TURF DETAIL  
3" = 1'-0"

**ABM**  
ARCHITECTS BEZALLEY MOLIERE

337 233 0614  
FAX 233 7338  
300 HEYMANN BOULEVARD  
LAFAYETTE, LOUISIANA 70503

ENLARGED SITE PLANS

**HURRICANE IDA REPAIRS TO TPCG BAYOU COUNTRY SPORTSPLEX**  
200 BAYOU COUNTRY PARKWAY  
HOUMA, LOUISIANA 70360



DATE ISSUED **10/11/2023**

REVISED

NO.	DESCRIPTION	DATE
1	ADDENDA No. 2	11/15/23

DRAWN BY \_\_\_\_\_ JBH

CHECKED BY \_\_\_\_\_ SBC

PROJECT NO. **202316.00**

SHEET NO. \_\_\_\_\_

C102R

These drawings are the property of Architects Bezalley Moliere and may not be used or copied in whole or in part without the written consent of the architect. Any infringement is subject to legal action.

MAINTENANCE BUILDING - RE: A101

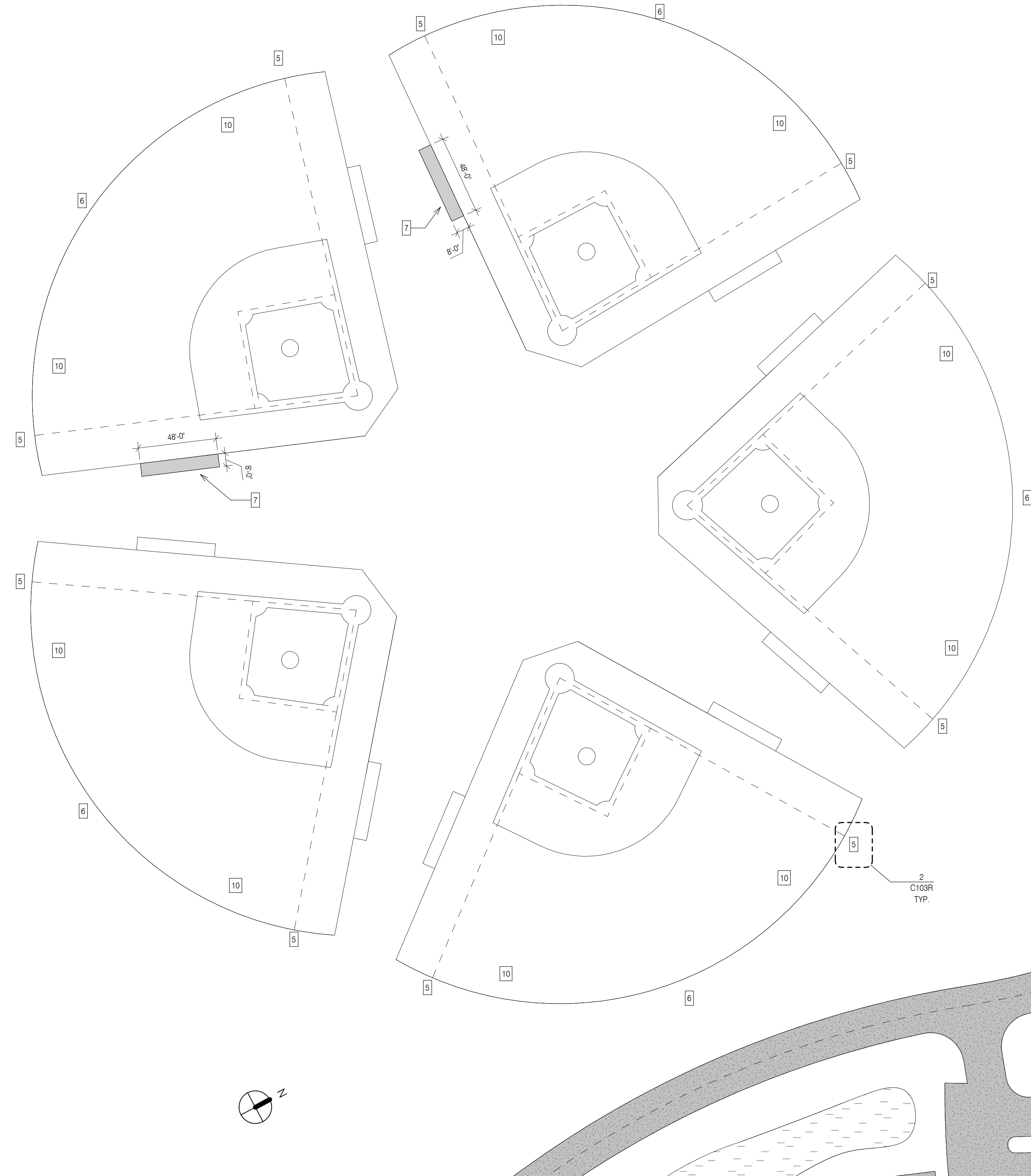
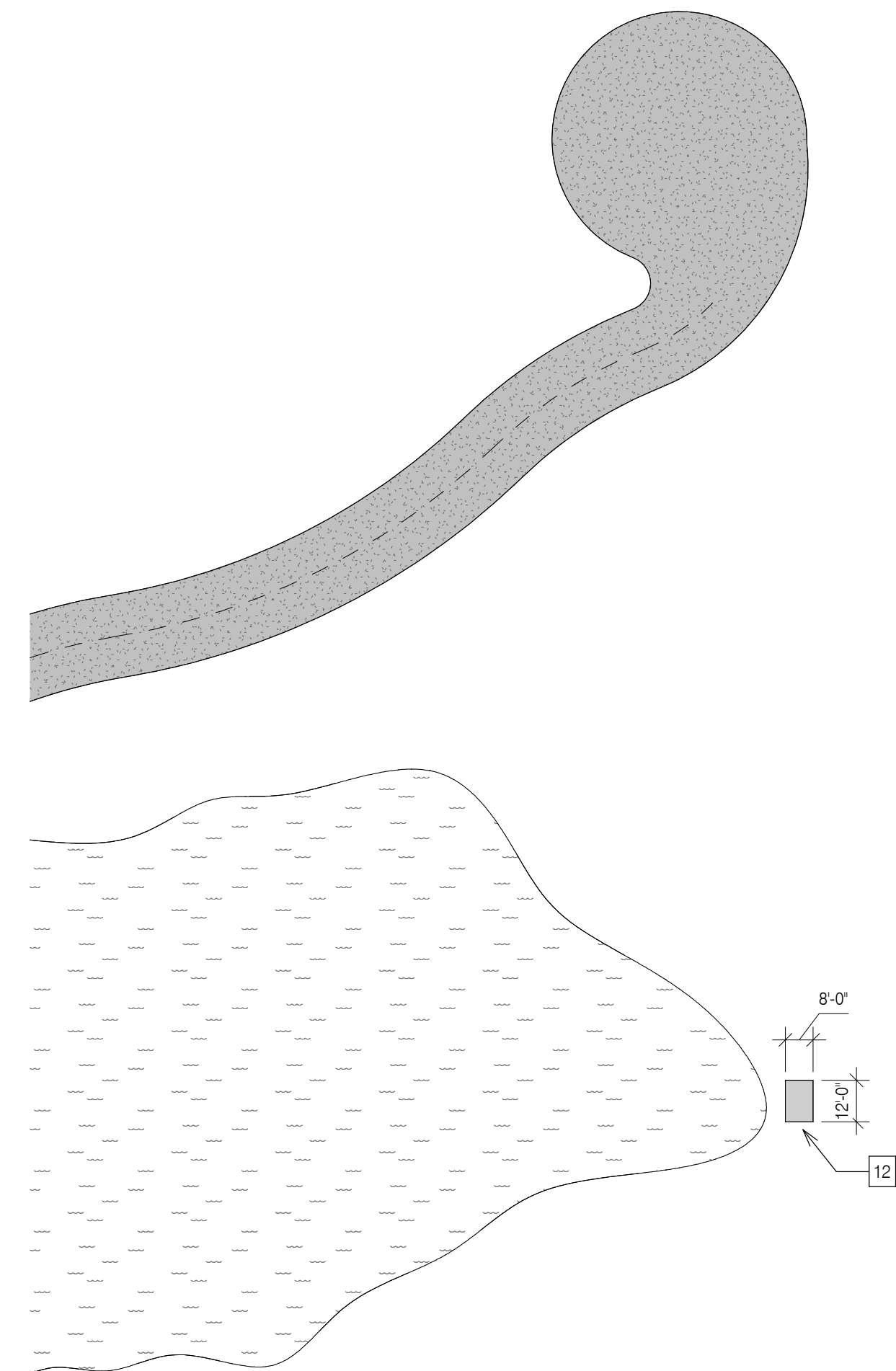

2  
C103R  
TYP.

REPAIR NOTES

1. REMOVE ALL 23 RECESSED LED SOFFIT LIGHT FIXTURES AND REPLACE WITH LIKE KIND. RE: A501 PHOTO #1
2. REPLACE ALL 20 MISSING PVC PILE CAPS WITH LIKE KIND. RE: A501 PHOTO #2
3. NOT IN USE
4. REPLACE MISSING BULKHEAD TOP PLATE WITH LIKE KIND. RE: A501 PHOTO #3
5. REMOVE FOUL POLE SLEEVES. REPLACE FOUL POLES, FLAGS, AND SLEEVES WITH LIKE KIND. COORDINATE EXACT LOCATION TO MEET LEAGUE REGULATIONS WITH THE PARK MANAGER. RE: A501 PHOTO #4-6
6. REPLACE MISSING YELLOW FENCE CAP WITH LIKE KIND. APPROXIMATELY 343 LINEAR FEET PER BALL FIELD. REUSE EXISTING FENCE CAP WHEN POSSIBLE. RE: A501 PHOTO #5, 6
7. REMOVE DAMAGED DUGOUT ROOF AND REPLACE DAMAGED/MISSING DUGOUT ROOF WITH LIKE KIND. RE: A501 PHOTO #7
8. REPLACE MISSING ARTIFICIAL TURF GRASS THROUGHOUT THE ENTIRE BATTING CAGE WITH LIKE KIND. INSTALL USING PRESSURE TREATED WOOD OR PLASTIC LUMBER ATTACHED TO THE SIDES OF THE SLAB. RE: A501 PHOTO #8
9. REPLACE DAMAGED 15 FOOT LONG, 3-TIER METAL BLEACHER WITH LIKE KIND. RE: A501 PHOTO #9
10. REPLACE MISSING COMMERCIAL SIGNAGE WITH LIKE KIND. (30' x 60' 3MM ALUMINUM COMPOSITE SPONSOR SIGNS)
11. REPLACE MISSING PA SPEAKER WITH LIKE KIND. RE: A501 PHOTO #10 (PRO 100 WEATHERPROOF OUTDOOR/INDOOR - RECTANGULAR SPEAKER CABINET 10" WOOFER W/ 2" HORN W/ 70 V TRANSFORMER - BLACK
12. REPLACE DAMAGED/MISSING METAL CANOPY AT WATER PUMP WITH LIKE KIND. RE: A501 PHOTO #11
13. REPLACE DAMAGED MISSING SURVEILLANCE CAMERA WITH LIKE KIND. RE: A501 PHOTO #12 (1 EA)
14. REMOVE DAMAGED GUTTER AND REPLACE WITH LIKE KIND. RE: A501 PHOTO #13
15. REMOVE DAMAGED DOWNSPOUTS AND REPLACE ALL 3 DAMAGED / MISSING DOWNSPOUTS WITH LIKE KIND. RE: A501 PHOTO #13
16. REMOVE DAMAGED METAL WALL PANEL AND REPLACE WITH LIKE KIND. RE: A501 PHOTO #14
17. REMOVE DAMAGED METAL CORNER TRIM AND REPLACE WITH LIKE KIND. RE: A501 PHOTO #15
18. NOT IN USE
19. REMOVE DAMAGED OVERHEAD ROLL-UP DOOR AND REPLACE WITH LIKE KIND. RE: A501 PHOTO #16
20. REMOVE THE REMAINS OF METAL AWNING SYSTEM AND REPLACE WITH LIKE KIND. PROVIDE COLUMNS, BRACKETS, HEADWALL FLASHING, RAKE AND EAVE TRIM AS REQUIRED BY MANUFACTURER TO MEET WIND LOADS. RE: A501 PHOTO #9
21. REMOVE DAMAGED METAL ROOF PANELS AND REPLACE WITH LIKE KIND. RE: A501 PHOTO #17

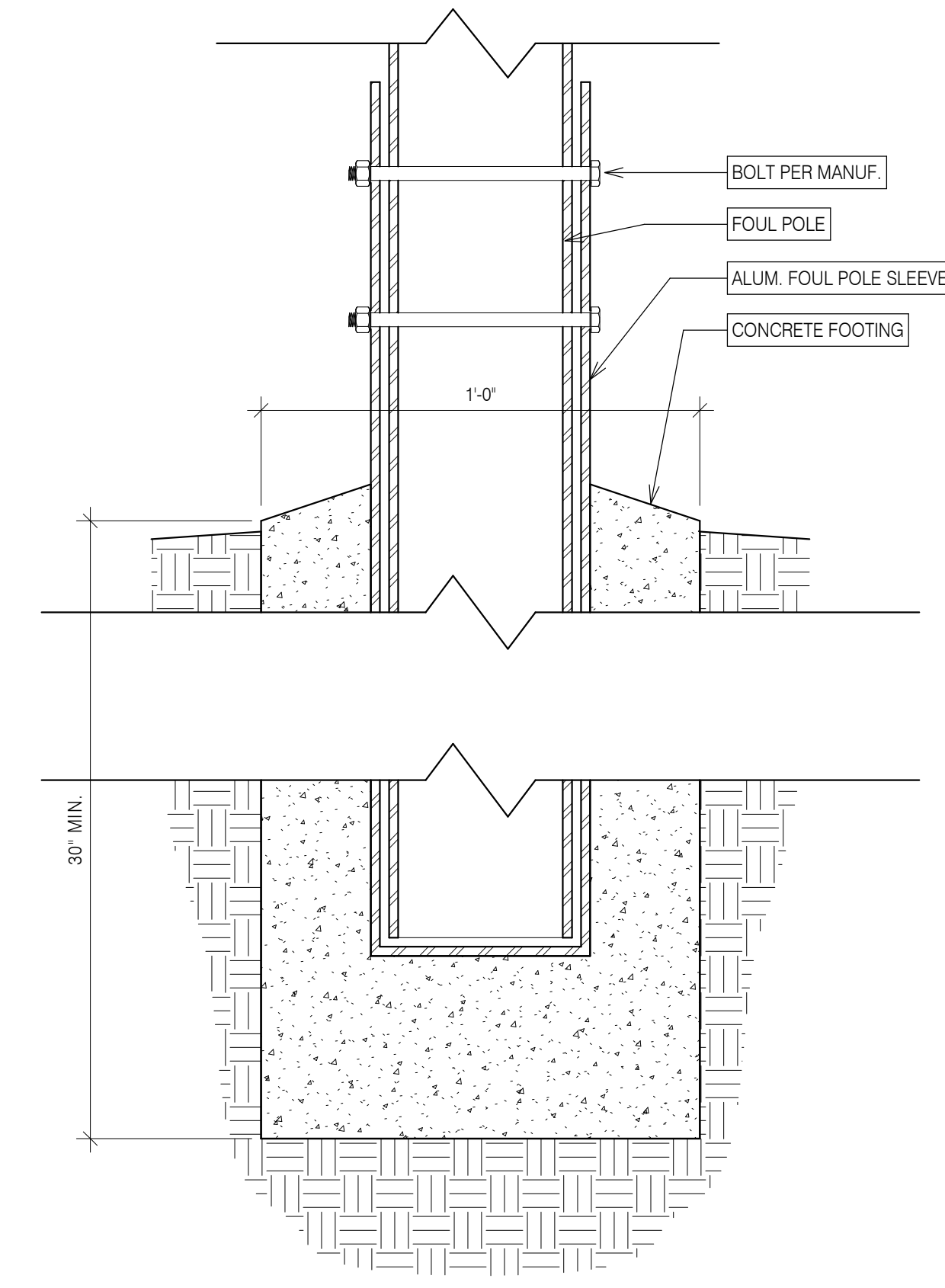

ENLARGED SITE PLANS

HURRICANE IDA REPAIRS TO TPCG BAYOU COUNTRY SPORTSPLEX  
200 BAYOU COUNTRY PARKWAY  
HOUMA, LOUISIANA 70360



DATE ISSUED 10/11/2023

REVISED

NO.	DESCRIPTION	DATE
1	ADDENDA No. 2	11/15/23

DRAWN BY JBH

CHECKED BY SBC

PROJECT NO. 202316.00

SHEET NO.

ARCHITECTS BEZALLEY MOLIERE  
  
 337 233 0614  
 FAX 233 7338  
 300 HEYMANN BOULEVARD  
 LAFAYETTE, LOUISIANA 70503



These drawings are the property of Architects Bezley Moliere and may not be used or copied in whole or in part without the written consent of the architect. Any infringement is subject to legal action.

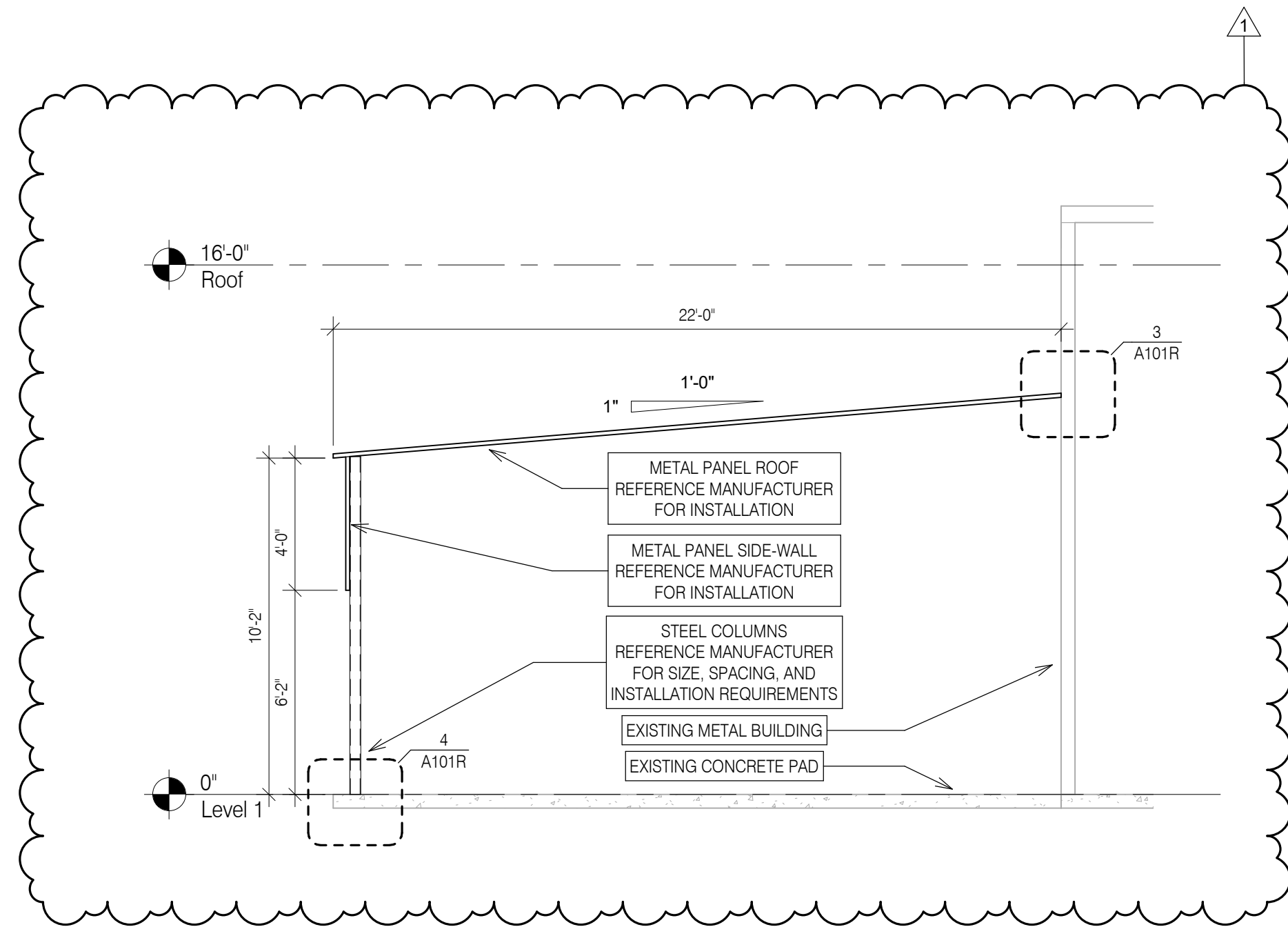

**1 AWNING SECTION**  
1/4" = 1'-0"

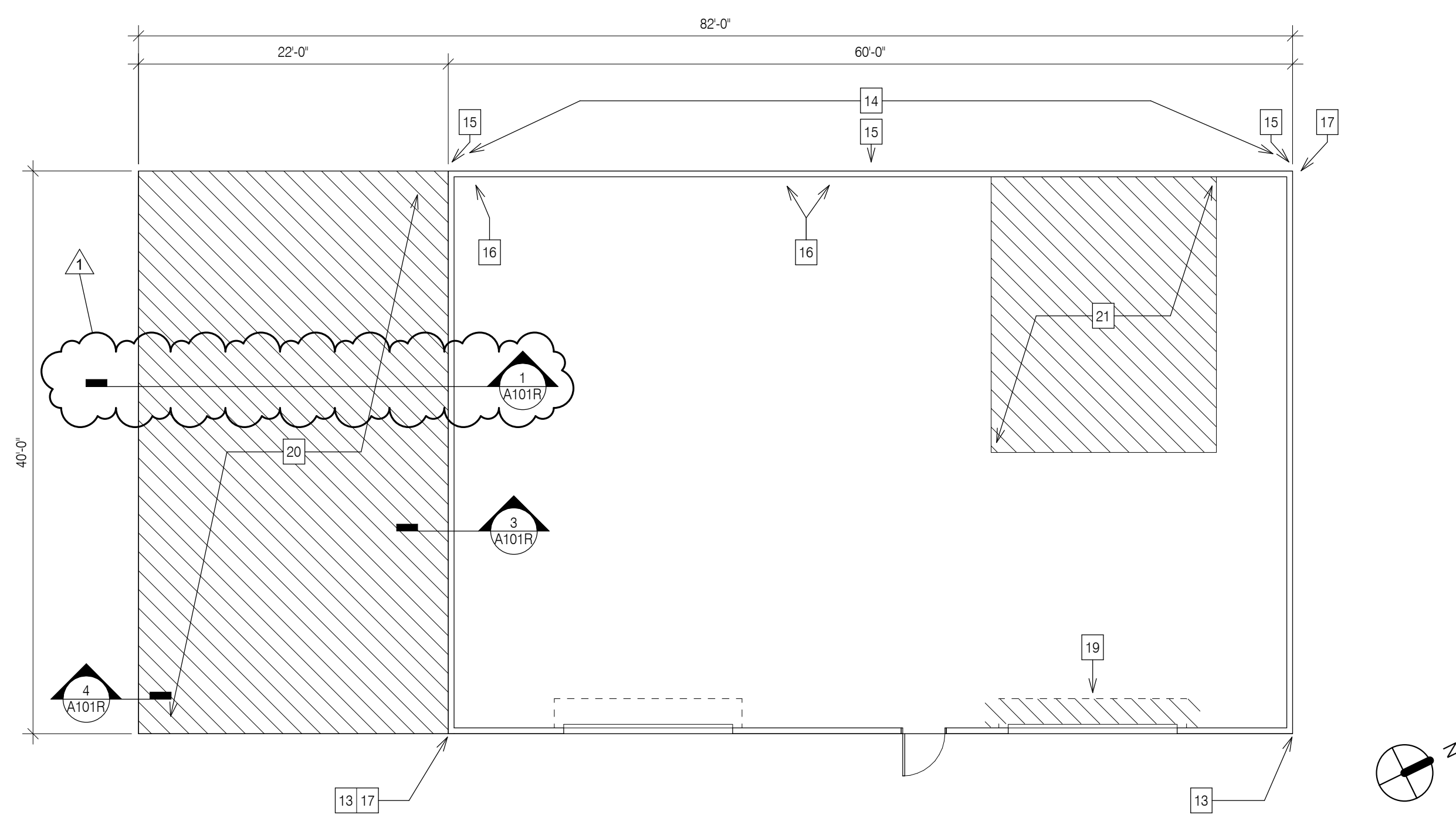

**2 1ST FLOOR PLAN**  
1/8" = 1'-0"

- ### REPAIR NOTES
1. REMOVE ALL 23 RECESSED LED SOFFIT LIGHT FIXTURES AND REPLACE WITH LIKE KIND. RE: A501 PHOTO #1
  2. REPLACE ALL 20 MISSING PVC PILE CAPS WITH LIKE KIND. RE: A501 PHOTO #2
  3. NOT IN USE
  4. REPLACE MISSING BULKHEAD TOP PLATE WITH LIKE KIND. RE: A501 PHOTO #3
  5. REMOVE FOUL POLE SLEEVES. REPLACE FOUL POLES, FLAGS, AND SLEEVES WITH LIKE KIND. COORDINATE EXACT LOCATION TO MEET LEAGUE REGULATIONS WITH THE PARK MANAGER. RE: A501 PHOTO #4-6
  6. REPLACE MISSING YELLOW FENCE CAP WITH LIKE KIND. APPROXIMATELY 343 LINEAR FEET PER BALL FIELD. REUSE EXISTING FENCE CAP WHEN POSSIBLE. RE: A501 PHOTO #5, 6
  7. REMOVE DAMAGED DUGOUT ROOF AND REPLACE DAMAGED/MISSING DUGOUT ROOF WITH LIKE KIND. RE: A501 PHOTO #7
  8. REPLACE MISSING ARTIFICIAL TURF GRASS THROUGHOUT THE ENTIRE BATTING CAGE WITH LIKE KIND. INSTALL USING PRESSURE TREATED WOOD OR PLASTIC LUMBER ATTACHED TO THE SIDES OF THE SLAB. RE: A501 PHOTO #8
  9. REPLACE DAMAGED 15 FOOT LONG, 3-TIER METAL BLEACHER WITH LIKE KIND. RE: A501 PHOTO #9
  10. REPLACE MISSING COMMERCIAL SIGNAGE WITH LIKE KIND. (30' x 60' 3MM ALUMINUM COMPOSITE SPONSOR SIGNS)
  11. REPLACE MISSING PA SPEAKER WITH LIKE KIND. RE: A501 PHOTO #10 (PRO 100 WEATHERPROOF OUTDOOR/INDOOR - RECTANGULAR SPEAKER CABINET 10" WOOFER W/ 2" HORN W/ 70 V TRANSFORMER - BLACK
  12. REPLACE DAMAGED/MISSING METAL CANOPY AT WATER PUMP WITH LIKE KIND. RE: A501 PHOTO #11
  13. REPLACE DAMAGED MISSING SURVEILLANCE CAMERA WITH LIKE KIND. RE: A501 PHOTO #12 (1 EA.)
  14. REMOVE DAMAGED GUTTER AND REPLACE WITH LIKE KIND. RE: A501 PHOTO #13
  15. REMOVE DAMAGED DOWNSPOUTS AND REPLACE ALL 3 DAMAGED / MISSING DOWNSPOUTS WITH LIKE KIND. RE: A501 PHOTO #13
  16. REMOVE DAMAGED METAL WALL PANEL AND REPLACE WITH LIKE KIND. RE: A501 PHOTO #14
  17. REMOVE DAMAGED METAL CORNER TRIM AND REPLACE WITH LIKE KIND. RE: A501 PHOTO #15
  18. NOT IN USE
  19. REMOVE DAMAGED OVERHEAD ROLL-UP DOOR AND REPLACE WITH LIKE KIND. RE: A501 PHOTO #16
  20. REMOVE THE REMAINS OF METAL AWNING SYSTEM AND REPLACE WITH LIKE KIND. PROVIDE COLUMNS, BRACKETS, HEADWALL FLASHING, RAKE AND EAVE TRIM AS REQUIRED BY MANUFACTURER TO MEET WIND LOADS. RE: A501 PHOTO #9
  21. REMOVE DAMAGED METAL ROOF PANELS AND REPLACE WITH LIKE KIND. RE: A501 PHOTO #17

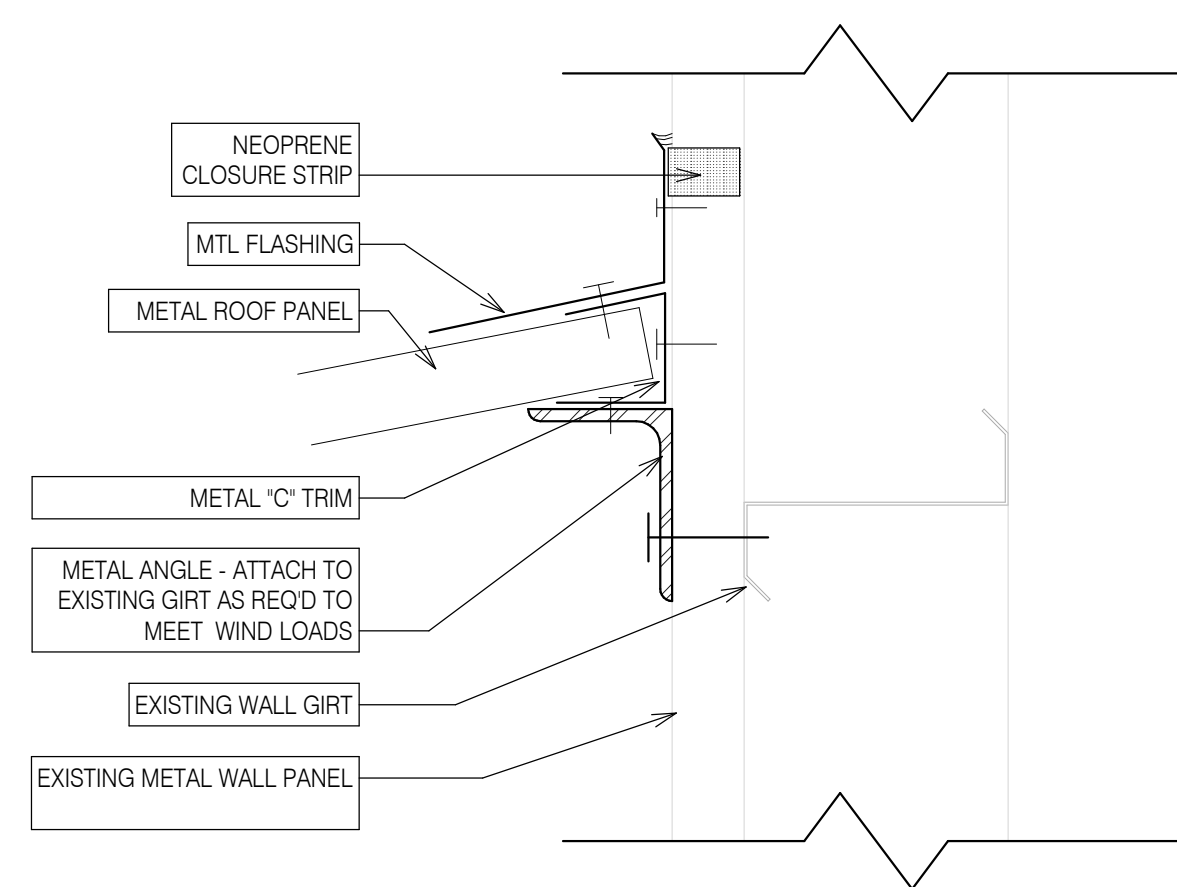

**3 CANOPY TIE-IN DETAIL**  
3" = 1'-0"

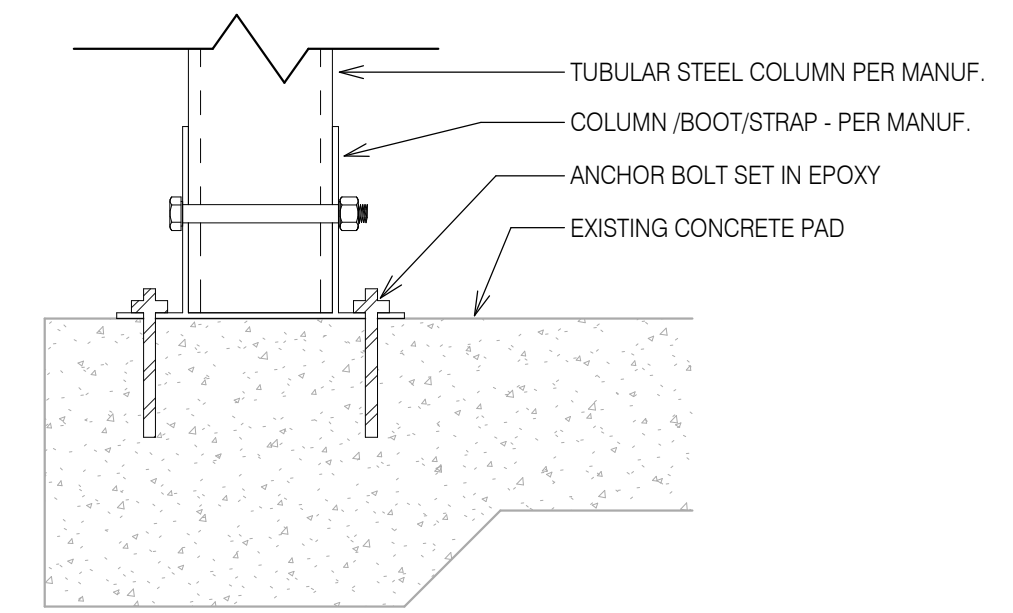

**4 CANOPY COL. BASE DETAIL**  
3" = 1'-0"

1ST FLOOR PLAN



DATE ISSUED **10/11/2023**

NO.	DESCRIPTION	DATE
1	ADDENDA No. 2	11/15/23

DRAWN BY **JBH**

CHECKED BY **SBC**

PROJECT NO. **202316.00**

SHEET NO.

**ARCHITECTS BEZLEY MOLIÈRE**  
  
 337 233 0614  
 FAX 233 7338  
 300 HEYMANN BOULEVARD  
 LAFAYETTE, LOUISIANA 70503

**HURRICANE IDA REPAIRS TO TPCG BAYOU COUNTRY SPORTSPLEX**  
 200 BAYOU COUNTRY PARKWAY  
 HOUMA, LOUISIANA 70360

**A101R**